



Baerz & Co

LUXURY HOMES

INTERNATIONAL



PROPERTY BROCHURE



Baerz & Co

LUXURY HOMES

INTERNATIONAL

by

Baerz & Co

LUXURY HOMES

ALCACER DO SAL

PORTUGAL

€875,000

ALCACER DO SAL

PORTUGAL



by
Baerz & Co
LUXURY HOMES

VRAAGPRIJS	€875,000
Soort woonhuis	House
Woonoppervlakte	320 m²
Perceeloppervlakte	801 m²



BAERZ PROPERTY FINDERS & ADVISORS

Carrer Brismar, 6
07157 Port d'Andratx

+31 20 210 1110
info@baerzproperty.com

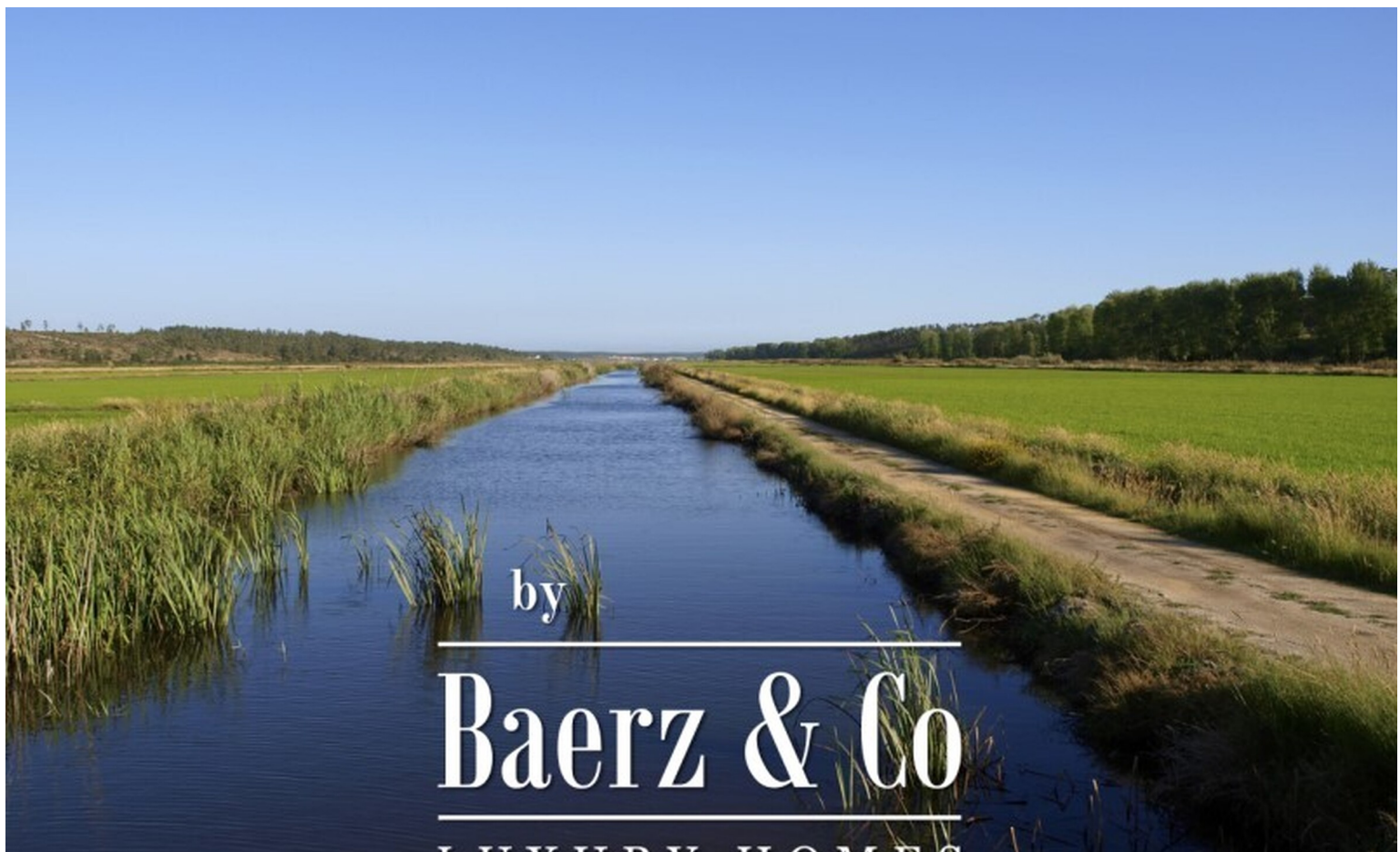

ALCACER DO SAL

PORTUGAL

INDELING

Aantal slaapkamers	6
Aantal badkamers	7



by

Baerz & Co

LUXURY HOMES



by

Baerz & Co

LUXURY HOMES

A photograph of a modern villa with a thatched roof and a swimming pool. The villa has a long, low profile with a steeply pitched, thatched roof made of natural materials. The walls are also finished with horizontal bands of the same thatched material, separated by light-colored horizontal panels. Large glass doors and windows are visible, reflecting the surrounding landscape. In the foreground, a swimming pool with a light blue interior is partially visible. The pool is surrounded by a sandy area and some low-lying plants. The background shows more of the villa and some trees under a clear sky.

by

Baerz & Co

LUXURY HOMES

ALCACER DO SAL

PORTUGAL

OMSCHRIJVING

Located in a gated community in the village of Brejos da Carregueira de Baixo, in Herdade da Comporta, in the middle of pine trees and nature, this exclusive plot with 801 m², has a project for a 6 bedroom villa with 320, 40 m² of construction.

The design of the villa was inspired by the concept of typical housing of the Alentejo coast, in the old fishermen's houses of the region, characterized by the large and bright spaces, on a single floor, giving prevalence to social areas and outdoor outdoor spaces.

All villas in the condominium must obey this type of moth.

The Brejos da Carregueira de Baixo are located in Herdade da Comporta, with direct and private access to exclusive beaches, 10 minutes by bike or buggy. 1 hour away from Lisbon and a 5-minute drive north to the village of Comporta or south to the village of Carvalhal, this location is very central and easy for those who like to frequent the good restaurant or need essential goods.

Walking distance to the exclusive beach, being situated in a gated community, in the middle of nature, makes this place idyllic for those who privilege peace and well-being.

Energy Rating: Exempt

#ref:CAS_6759



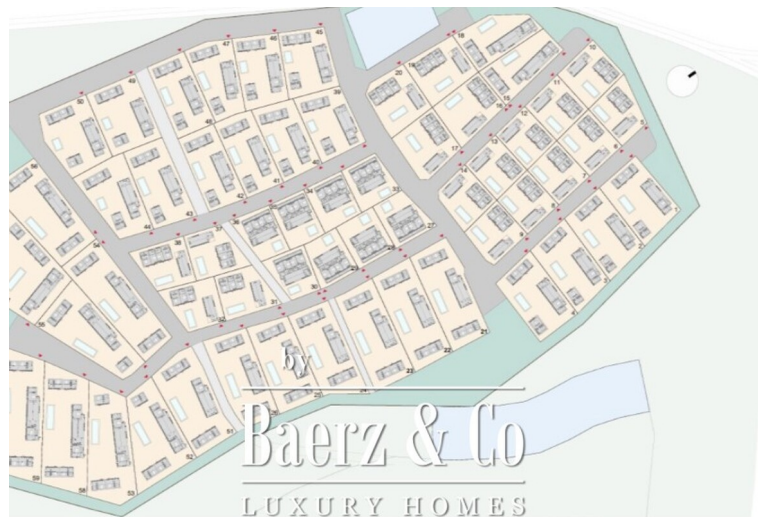



Baerz Property Finders & Advisors

Carrer Brismar, 6
07157 Port D'andratx

+31 20 210 1110

info@baerzproperty.com

WWW.BAERZPROPERTY.COM



WWW.BAERZ.COM